

# BIG

## REICK'S SMOKE STOPPER



The portable smoke stopper.

- Prevents smoke and heat spread in burning buildings
- Fast and safe installation into doors and entrances
- Adjustable - fits all common door sizes and designs
- Lightweight and compact
- Heat resistant fabric - up to 600°C
- Easy to pass for fire fighters when installed
- Perfect complement to Positive Pressure Ventilation



## Operation of the *REICK'S SMOKE STOPPER*

The portable smoke stopper prevents the spread of smoke and heat in not affected areas of burning buildings.

It is fast clamped into the doorway with the easily operated, infinitely adjustable tension lever. Is there smoke and heat behind the door, the smoke stopper reduces the spread of smoke strongly when the door is opened by the fire fighters.

The smoke is restrained effectively while it is possible to enter or exit the scene of the fire anytime and without difficulty.

The fire fighters can directly use positive pressure ventilation to ventilate the stairways and get them smoke-free without streaming in of additional smoke from the burning areas. The smoke stopper helps the fire fighters to avoid the spread of smoke and heat during the attack of the fire.

Emergency exits for the residents and escape ways for the fire fighters stay smoke-free. It is possible for the security backup to stay close to the attacking fire fighters.

Dangerous situations through smoke spread are effectively minimized or avoided.



Without RSS the staircase is filled up with smoke.

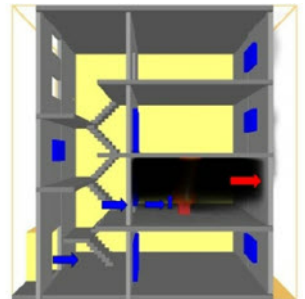

With RSS the smoke stays in the burning flat.



### Technical Data

#### RSS Standard

Transport Size: 73 cm x 54 cm x 4 cm  
Weight: 4,8 kg  
Usable for door width: 69 cm to 118 cm

#### RSS Special Size 90/140

Transport Size: 93 cm x 54 cm x 4 cm  
Weight: 5,4 kg  
Usable for door width: 90 cm to 140 cm

#### RSS Special Size 90/150

Transport Size: 93 cm x 54 cm x 4 cm  
Weight: 5,8 kg  
Usable for door width: 90 cm to 150 cm

**BIG**

